

# MHT LIGHTING

PoE FIXTURE

Line Voltage Fixture

## DL Series

LED ROUND DOWN LIGHT Series

### FEATURES

- PoE Enabled that works with Inspextor
- 0-10V Line Voltage Available

### GENERAL INFORMATION

Applications Airports, Corporate Campuses, Data Centers, Retail, and Health-care Facilities

Warranty 5-year Limited Warranty

Construction Die-cast Aluminum Wet Rated Housing with Stainless Steel Clips  
Lens: White Polycarbonate

Certifications



### PRODUCT DATA

Electrical Non-Integrated PoE Low Voltage Driver Node or 0-10V Driver

Mounting Recessed ceiling mount

Lumens 1,000 - 1,550 Lumens

Max Input Power 9/11/14W

CRI > 80

CCT 3000K/3500K/4000K/5000K

L70 Lifetime > 50,000 Hours

Rated Lifespan > 60,000 Hours

Dimensions 4-inch Model: 5.7" x 1.9"  
6-inch Model: 7.7" x 1.9"



### DIMENSIONS

4-inch Model

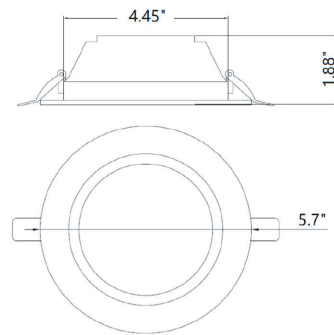

### PHOTOMETRICS

MHTi-DL-SC-4-9E  
Luminaire Output: 1,000 lumens, 9 Watts

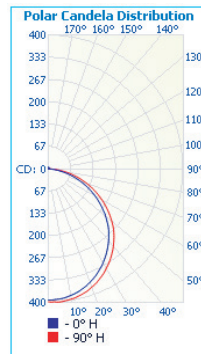

	Center Beam fc	Beam Width	
1.5ft	174 fc	4.0 ft	4.1 ft
3.0ft	43.4 fc	8.0 ft	8.2 ft
4.5ft	19.3 fc	12.0 ft	12.3 ft
6.0ft	10.9 fc	16.0 ft	16.4 ft
7.5ft	6.95 fc	20.0 ft	20.5 ft
9.0ft	4.82 fc	24.0 ft	24.5 ft

■ Vert. Spread: 106.2°  
■ Horiz. Spread: 107.5°

### FIXTURE PERFORMANCE

Model	Max Wattage	Lumens/Watt
MHT-DL-4-9W	9W	110 lm/W
MHT-DL-4-11W	11W	110 lm/W
MHT-DL-6-11W	11W	110 lm/W
MHT-DL-6-14W	14W	110 lm/W

ORDERING INFO: Sample Code - MHTi-DL-SC-4-9W-35K

**MHT Technologies**

Series	Size & Wattage	Color Temperatures	Options
MHT-DL			
PoE: MHTi-DL-SC LV: MHTL-DL	4-9W - 4" Round 9W (PoE/LV) 4-11W - 4" Round 11W (PoE/LV) 6-11W - 6" Round 11W (PoE/LV) 6-14W - 6" Round 14W (PoE/LV)	3K - 3000K 35K - 3500K 4K - 4000K 5K - 5000K	(Blank) - Standard in White Trim